

NOVIA DO 103/145 Monolithic Breather

Permeable roof underlay for use directly onto insulation or boarding.

NOVIA

Novia Ltd

Unit 12 Heronden Road
Park Wood Industrial Estate
Maidstone, Kent. ME15 9YR

Novia DO 103/145 is a high performance monolithic roof-underlay with excellent water vapour transmission characteristics, and superb water resistance. Designed for direct installation over insulation, boarded roofs or rafters. Suitable for all pitched cold and warm roofs.

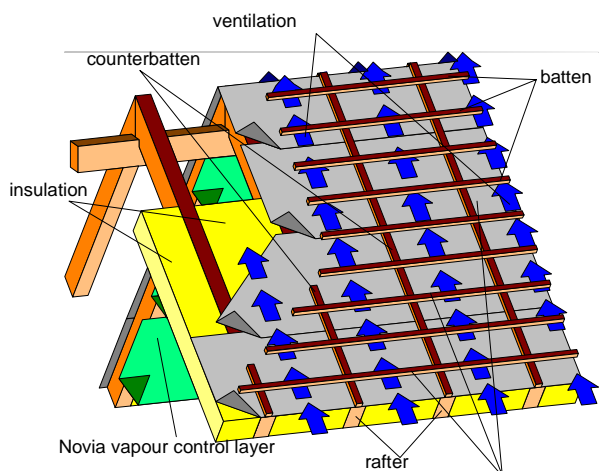

Novia DO 103/145
Breathable roof underlay

- ✓ **Water resistant monolithic membrane (no holes to clog)**
- ✓ **High breathability**
- ✓ **Flame and UV - resistant**
- ✓ **Low weight, high tear and nail tear strength, matt finish slip-resistant surface**
- ✓ **Simple handling and easy to use**
- ✓ **Easy to recycle**

Composition:



PP - non woven black UV
permeable membrane
PP - non woven black UV

Size:

Standard width	1.5	m
Roll length	50	m
Roll weight	11	kg
Packing unit	40	rolls per pallet

Technical data:

			Test method
Weight:	~ 145	g/m ²	EN 1849-2
Tensile strength:	~ 250/180	N/50mm	EN 12311-1
Elongation:	~ 55/60	%	EN 12311-1
Tear resistance:	~ 180/190	N	EN 12310-1
Water vapour transmission rate:	~ 360 +/- 130	g/m ² d	ASTM F-1249-90
Sd-value:	~ 0,10	m	
Resistance to water penetration:	> 400	hPa	EN 13111
Flame resistance:	B2		DIN 4102
Temperature resistance:	-40 to +80	°C	
UV - resistance:	3	month	

Highly breathable monolithic roof underlay for use directly over insulation

Novia DO 103/145

Installation instructions:

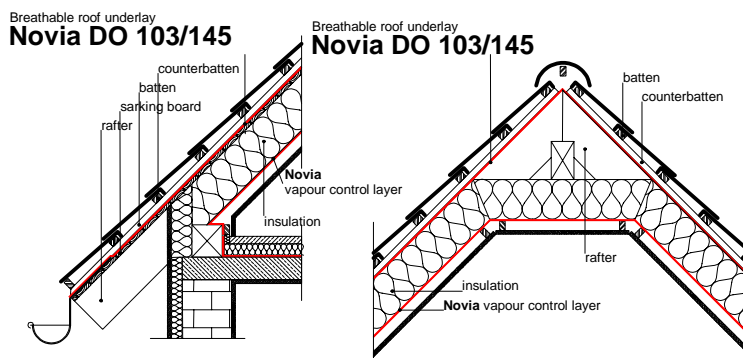

- Handle material carefully to prevent tears and punctures. Repair any damage which does occur with adhesive tape.
- Lay **Novia DO 103/145** starting at the eaves horizontally across the rafters, with a horizontal overlap of 100 to 150 mm (pre-printed overlap), if the slope is greater than 25°. Use a 200 mm overlap if the slope is less than 25°.
- On insulated warm roofs **Novia DO 103/145** can be placed directly on to the insulation and also on boarded roofs.
Novia DO 103/145 can also be used in conventional cold roof applications.
- The membrane should be overlapped 200 mm on each side of the ridge.
- All vertical overlaps must be situated on a rafter and must be sealed.
- Temporarily fix **Novia DO 103/145** in place directly onto the rafters. Then permanently fix **Novia DO 103/145** to rafters through counter-battens (laid above the rafters).
- Seal any nail damage as necessary. **Novia DO 103/145** is UV resistant and can be exposed on site for a period not exceeding 3 months.
- At any entry points for services (soil pipes, vents etc.) ensure that **Novia DO 103/145** is properly sealed.
- Where pipes etc. penetrate the underlay cut neatly and accurately and turn edges up to give a tight water-resistant fit.
- Ensure that for warm roof applications, a vapour barrier is installed beneath the insulation.
- Ensure that sufficient ventilation is incorporated to comply with building regulations and technical standards.

Novia DO 103/145 will reduce the risk of condensation within the roof space but in certain atmospheric conditions it can never be totally eliminated.