

# NOVIA DO 93/135 Reflex

Vapour permeable underlay for use directly onto insulation or boarding if required, in roof and wall applications.

NOVIA

Novia Ltd

Unit 12 Heronden Road

Park Wood Industrial Estate

Maidstone, Kent. ME15 9YR

01622 678952

**NOVIA DO 93/135 Reflex** is a reflective metallic-faced breather membrane. This low weight, high performance building membrane is suitable as a breathable roof or wall underlay. It has excellent water resistance and is suitable for direct installation over insulation, boarded roofs or rafters. Suitable for all pitched cold and warm roofs.

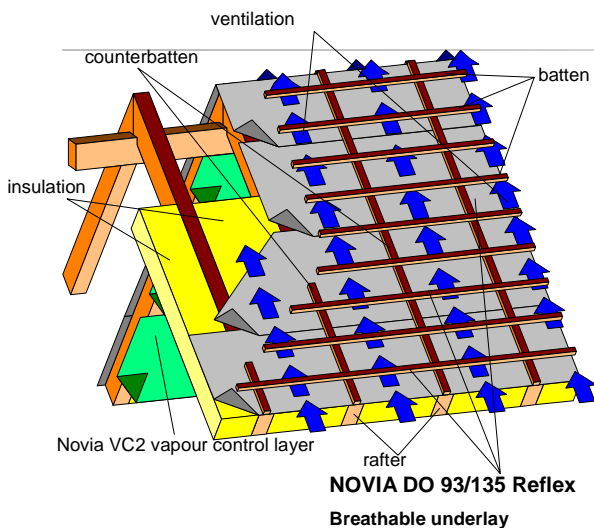

## Composition:

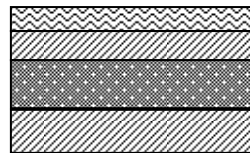

metallised PP - non woven

PP - breathable film

PP - non woven

## Size:

Standard width	1.5	m
Roll length	50	m
Roll weight	10	kg
Packing unit	50	rolls per pallet

- ✓ For both roof and wall applications
- ✓ 3-layer laminate with low emissivity and high reflectivity
- ✓ Breathable membrane with excellent waterproofing properties
- ✓ High breathability
- ✓ Flame and UV resistant
- ✓ Low weight, high tear and nail tear strength, matt finish slip-resistant surface
- ✓ Fully compliant to new CE Standards
- ✓ Easy to recycle

## Technical data:

			Test method
Weight:	~ 135	g/m <sup>2</sup>	EN 1849-2
Tensile strength:	~ 220/170	N/50mm	EN 12311-1
Elongation:	~ 45/85	%	EN 12311-1
Tear resistance:	~ 230/280	N	EN 12310-1
Water vapour transmission rate:	~ 600 +/- 200	g/m <sup>2</sup> d	ASTM F-1249-90
Sd-value:	~ 0,05	m	
Resistance to water penetration:	> 250	hPa	EN 13111
reflectivity	66	%	internal
Flame resistance:	B2 (E)		DIN 4102
Temperature resistance:	-40 to +80	°C	
UV - resistance:	2	month	

Highly breathable underlay for use directly over insulation if required

# Novia DO 93/135 Reflex

## Installation instructions:

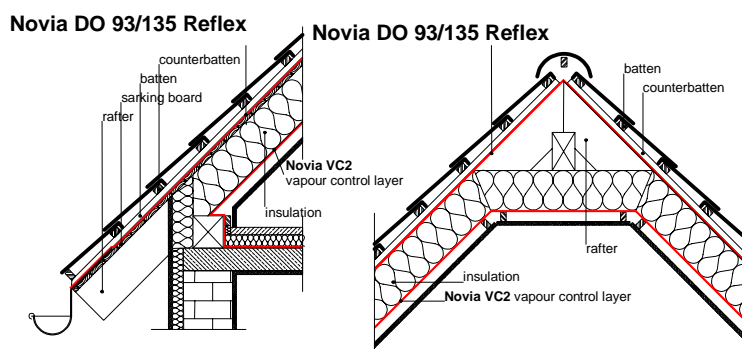

- Handle material carefully to prevent tears and punctures. Repair any damage which does occur with adhesive tape.
- Lay **Novia DO 93/135** starting at the eaves horizontally across the rafters, with a horizontal overlap of 100 to 150 mm (pre-printed overlap), if the slope is greater than 25°. Use a 200 mm overlap if the slope is less than 25°.
- On insulated warm roofs **Novia DO 93/135** can be placed directly on to the insulation and also on boarded roofs. **Novia DO 93/135** can also be used in conventional cold roof applications.
- The membrane should be overlapped 200 mm on each side of the ridge.
- All vertical overlaps must be situated on a rafter and must be sealed.
- Temporarily fix **Novia DO 93/135** in place directly onto the rafters. Then permanently fix **Novia DO 93/135** to rafters through counter-battens (laid above the rafters).
- Seal any nail damage as necessary. **Novia DO 93/135** is UV resistant and can be exposed on site for a period not exceeding 2 months.
- At any entry points for services (soil pipes, vents etc.) ensure that **Novia DO 93/135** is properly sealed.
- Where pipes etc. penetrate the underlay cut neatly and accurately and turn edges up to give a tight water-resistant fit.
- Ensure that for warm roof applications, a vapour barrier such as **Novia VC2** is installed beneath the insulation, as only 1 - 3% moisture contamination within the insulation can affect its performance by up to one third.
- Ensure that sufficient ventilation is incorporated to comply with building regulations and technical standards.
- **Novia DO 93/135** will reduce the risk of condensation within the roof space but in certain atmospheric conditions it can never be totally eliminated.